

CENTER TOWNSHIP SECTION 9 R10- TWP 6 MORGAN COUNTY, OH

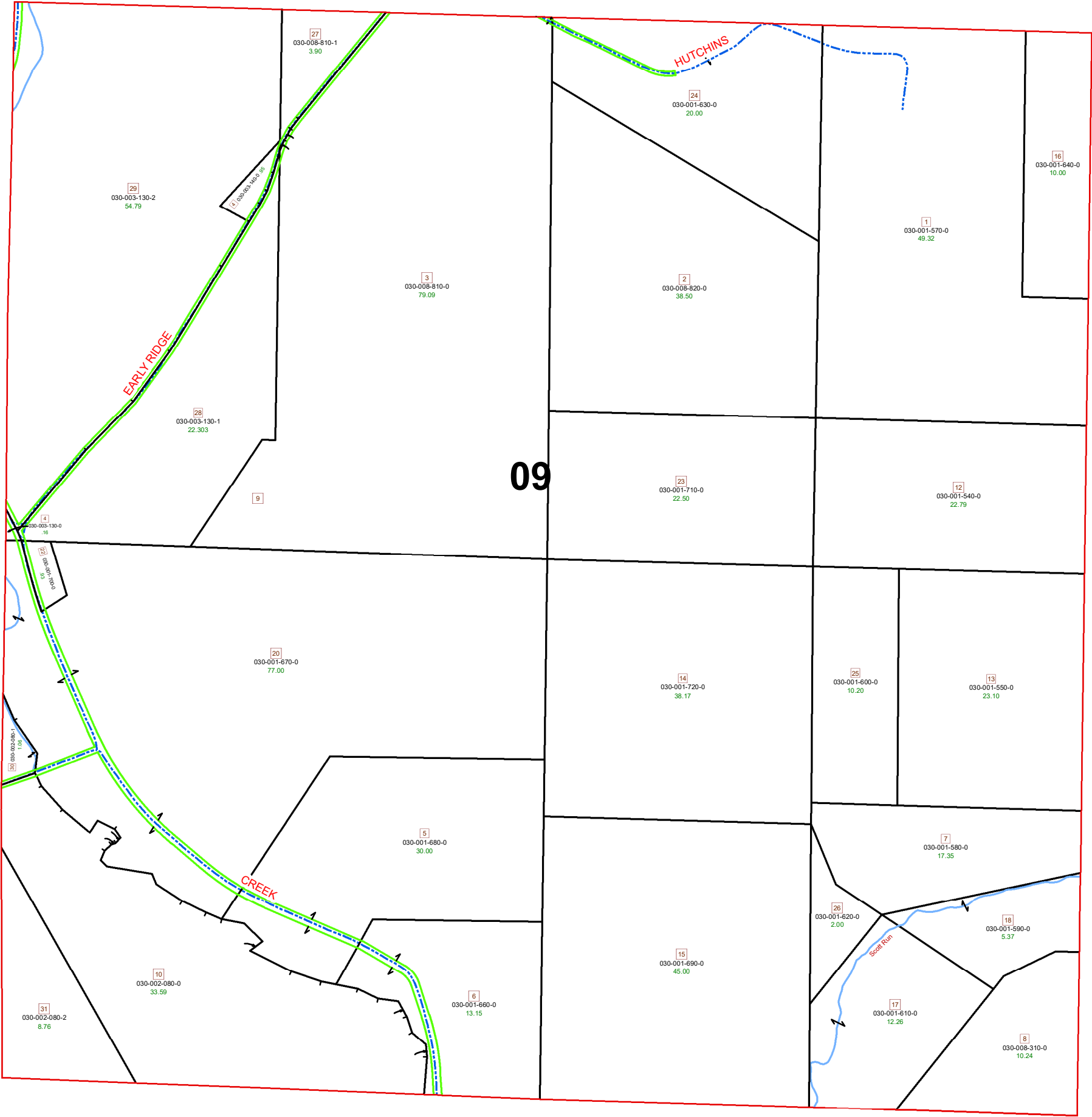

| PIN | VOL | PAGE | Owner | LegalDescr | Acres |
|---------------|---------|------|---------------------------|---------------------|--------|
| 030-003-130-0 | OR200 | 557 | BICKFORD DENNIS L | R10 T06 S09 SD 4 | 0.169 |
| 030-001-660-0 | OR230 | 1 | CNX LAND LLC | R10 T06 S09 SD 6 BE | 13.15 |
| 030-001-620-0 | OR230 | 1 | CNX LAND LLC | R10 T06 S09 SD 26 T | 2 |
| 030-001-690-0 | OR230 | 1 | CNX LAND LLC | R10 T06 S09 SD 15 B | 45 |
| 030-001-580-0 | OR230 | 1 | CNX LAND LLC | R10 T06 S09 SD 7 T | 17.35 |
| 030-001-680-0 | OR230 | 1 | CNX LAND LLC | R10 T06 S09 SD 5 BE | 30 |
| 030-001-550-0 | OR230 | 1 | CNX LAND LLC | R10 T06 S09 SD 13 | 23.1 |
| 030-001-600-0 | OR230 | 1 | CNX LAND LLC | R10 T06 S09 SD 25 T | 10.2 |
| 030-001-720-0 | OR230 | 1 | CNX LAND LLC | R10 T06 S09 SD 14 B | 38.17 |
| 030-001-700-0 | OR230 | 1 | CNX LAND LLC | R10 T06 S09 SD 22 B | 0.93 |
| 030-001-670-0 | OR230 | 1 | CNX LAND LLC | R10 T06 S09 SD 20 B | 77 |
| 030-001-540-0 | OR230 | 1 | CNX LAND LLC | R10 T06 S09 SD 12 | 22.79 |
| 030-001-710-0 | OR230 | 1 | CNX LAND LLC | R10 T06 S09 SD 23 B | 22.5 |
| 030-001-640-0 | OR230 | 1 | CNX LAND LLC | R10 T06 S09 SD 16 T | 10 |
| 030-001-570-0 | OR230 | 1 | CNX LAND LLC | R10 T06 S09 SD 1 T | 49.32 |
| 030-001-630-0 | OR230 | 1 | CNX LAND LLC | R10 T06 S09 SD 24 T | 20 |
| 030-001-610-0 | OR230 | 1 | CNX LAND LLC | R10 T06 S09 SD 17 T | 12.26 |
| 030-001-590-0 | OR230 | 1 | CNX LAND LLC | R10 T06 S09 SD 18 T | 5.37 |
| 030-008-810-1 | OR232 | 5800 | FOSS MADONNA L & JAMMIE | R10 T06 S09 SD 27 S | 3.906 |
| 030-003-130-2 | OR232 | 5800 | FOSS MADONNA L & JAMMIE | R10 T06 S09 SD 29 S | 54.799 |
| 030-002-080-0 | OR234 | 551 | MILLER THOMAS D & SARAH | R10 T06 S09 SD 10 S | 33.598 |
| 030-003-140-0 | OR232 | 2926 | REESE RANDEN W & STEPHANI | R10 T06 S09 4 SURV | 0.959 |
| 030-003-130-1 | OR200 | 551 | SILVUS SANDY & JENNY | R10 T06 S09 SD 28 S | 22.303 |
| 030-008-310-0 | OR233 | 349 | TRACEY IRREVOCABLE FAMIL | R10 T06 S09 SD 8 S | 10.24 |
| 030-002-080-1 | OR207 | 2582 | WELCH JERRY M & VICTORIA | R10 T06 S09 SD 30 S | 1.061 |
| 030-002-080-2 | OR223 | 1622 | ZIELENIEWSKI JOHN | R10 T06 S09 SD 31 | 8.765 |
| 030-008-820-0 | D.V 205 | 636 | ZIMMERMAN JAMES D & BEUL | R10 T06 S09 SD 2 | 38.5 |
| 030-008-810-0 | OR92 | 245 | ZIMMERMAN JAMES D & BEUL | R10 T06 S09 SD 3-9 | 79.094 |

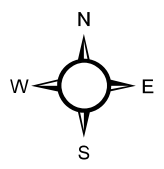

| Boundaries | | Type | |
|--|----------|--|-------|
| | Sections | | Hydro |
| | Parcel | | Roads |
| | ROW | | Lot |
| | Hidden | | |

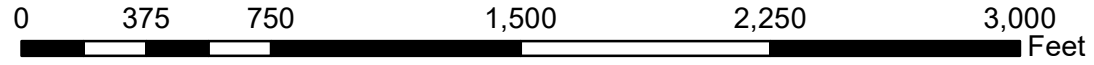

Source: Morgan County Engineer's Office
 Author: Marcia Wolfe
 Date: 3/13/2020

Disclaimer: The information that these maps contains is or reference purposes only. Please bring any erros to the attention of the Engineer's Office staff.
 Thank you